

5

4

3

2

1

REVISIONS						
ZONE	LTR	DESCRIPTION	DATE	E.M.N.NO	DRAFT	CHKD APPD

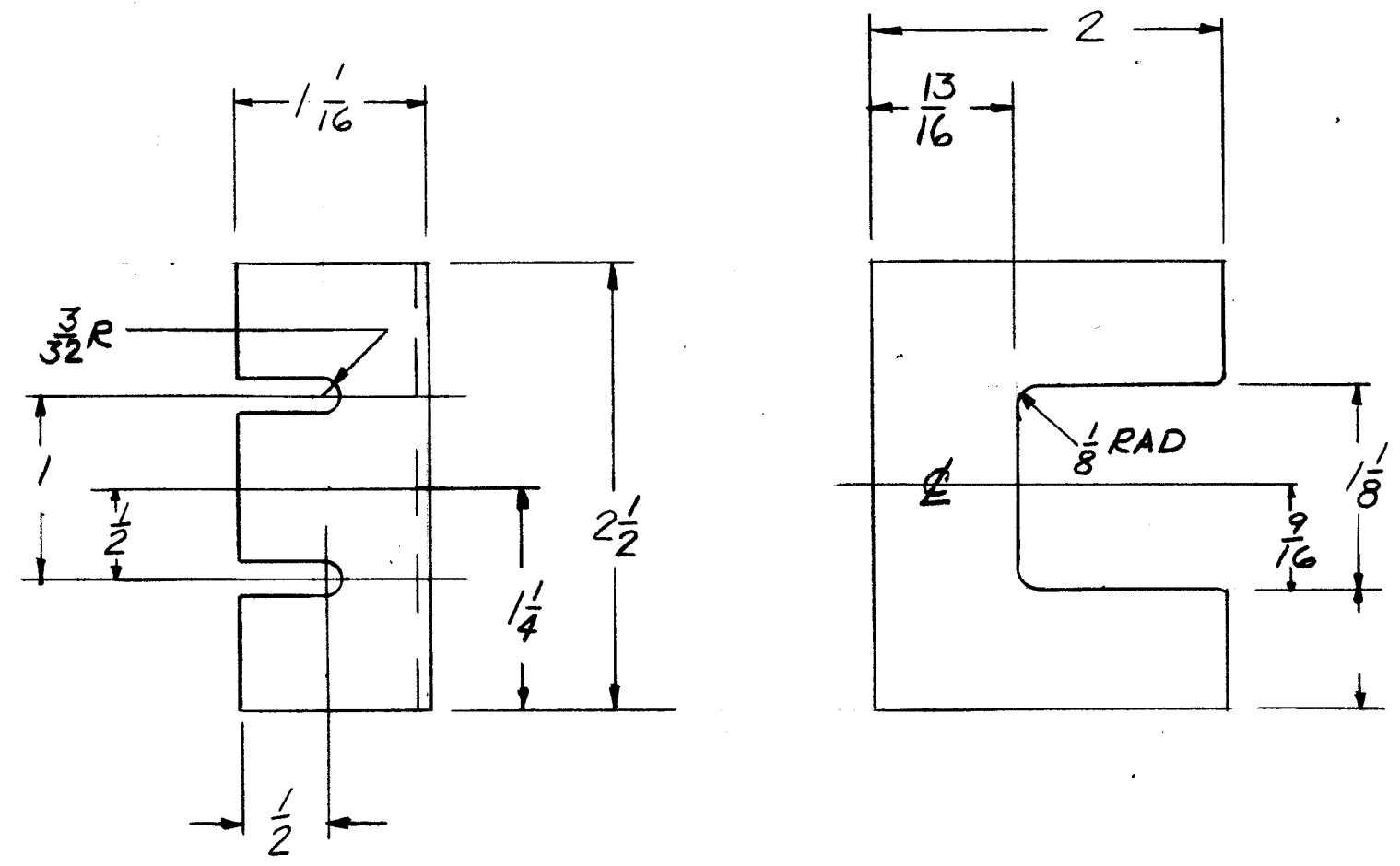

NOTE
BREAK ALL SHARP CORNERS

REQ'D	ITEM	PART NUMBER	DESCRIPTION	SYM.
LIST OF MATERIAL				
THE TECHNICAL MATERIEL CORP. MAMARONECK, NEW YORK				
CONN. LOCKING BKT RT27 ≠ UNIT 13A				
SIZE		CODE IDENT. NO.	DWG NO.	ISSUE
B		82679	MS8203	Ø
SCALE: FULL			SHEET	OF

UNLESS OTHERWISE SPECIFIED DIMENSIONS ARE IN INCHES AND INCLUDE CHEMICALLY APPLIED OR PLATED FINISHES		FINAL APPROVAL	DATE
		<i>[Signature]</i>	6-1-68
		MECH. DES.	DATE
		<i>[Signature]</i>	3-1-68
		ELECT. DES.	DATE
		<i>[Signature]</i>	3-1-68
		CHECKED	DATE
		<i>[Signature]</i>	5-7-68
		DRAWN	DATE
		<i>[Signature]</i>	3-3-68

QTY / UNIT	MODEL USED ON	ASS'Y NO.
	1/13A RT-27	
APPLICATION		
CODE		
<p>NOTICE TO PERSONS RECEIVING THIS DRAWING THE TECHNICAL MATERIEL CORPORATION claims proprietary right in the material disclosed hereon. This drawing is issued in confidence for engineering information only and may not be reproduced or used to manufacture anything shown hereon without permission from THE TECHNICAL MATERIEL CORPORATION to the user. This drawing is loaned for mutual assistance and is subject to recall at any time.</p>		
MATERIAL		
.064 ALUM. 5052-H32		
FINISH		
S404 IRIDITE		