

REVISIONS

APPLICATION		DESCRIPTION		DATE		E.M.N.NO		DRAFT		CHKD		APPD	
QTY	MODEL USED ON	ASS'Y NO.	LTR	DESCRIPTION	DATE	E.M.N.NO	DRAFT	CHKD	APPD				
	TTRT()D		X	EXPERIMENTAL RELEASE	5/23/68		JW						
			Ø	ORIGINAL RELEASE	5/23/68		JW		JW				

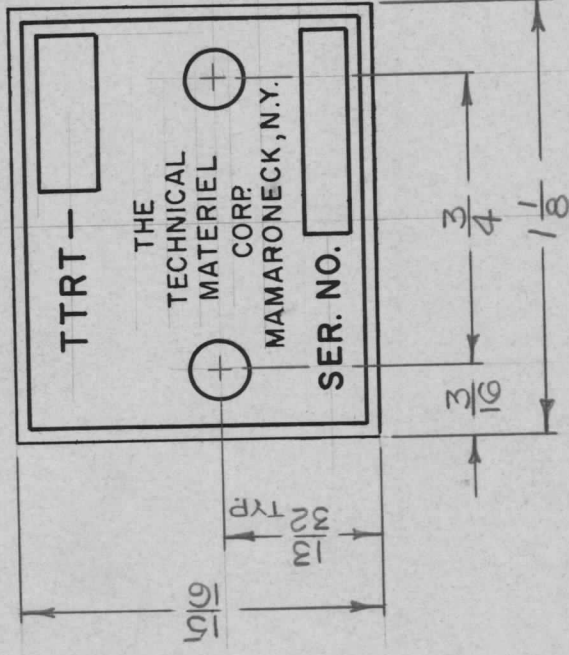

2 HOLES: 9/64 DIA.
 BORDER: 1/16
 SERIAL BLOCK: 1/8 X 17/32
 MODEL BLOCK: 5/32 X 13/32

MATERIAL NOTE:

.032 THK ALUMINUM
 ALCAN 2S-H OR
 ALCAN 3S-H
 ALCOA 2S-H15

NOTES:

- FINISH: REVERSE ETCH, LUSTERLESS BLACK (37038) BACKGROUND PER FED-STD-595
- TYPE FACE: LETTERING TO BE GOTHIC OR SPARTAN; W/MODIFIER (HEAVY, MEDIUM, CONDENSED, ETC) AS REQUIRED TO FIT SPACE
- IDENTIFICATION PLATE TO BE MANUFACTURED IN ACCORDANCE WITH MIL-P-15024 AND AMENDS (TYPE A)

UNLESS OTHERWISE SPECIFIED DIMENSIONS ARE IN INCHES AND INCLUDE CHEMICALLY APPLIED OR PLATED FINISHES				REQ'D ITEM		PART NUMBER		DESCRIPTION		SYM.	
DECIMALS		FRACTIONS		FINAL APPROVAL		MECH. DES.		ELECT. DES.		CHECKED	
.X ± .05	TOLS.	1/64		DATE		DATE		DATE		DATE	
.XX ± .01	ANGLES	0° .30'		DATE		DATE		DATE		DATE	
.XXX ±				DATE		DATE		DATE		DATE	
MATERIAL SEE MATERIAL NOTE				LIST OF MATERIAL							
FINISH				THE TECHNICAL MATERIEL CORP. MAMARONECK, NEW YORK							
PLATE, IDENTIFICATION				SIZE CODE IDENT. NO. DWG NO. NP 934							
SCALE 2:1				SHEET OF							

NOTICE TO PERSONS RECEIVING THIS DRAWING
 THE TECHNICAL MATERIEL CORPORATION claims proprietary right in the material disclosed hereon. This drawing is issued in confidence for engineering information only and may not be reproduced or used to manufacture anything shown hereon without permission from THE TECHNICAL MATERIEL CORPORATION to the user. This drawing is loaned for mutual assistance and is subject to recall at any time.