

REQ. PER UNIT	USED ON			PX-692	A
	MODEL	ASS'Y. NO.	DATE		
	GPT-200K	AX-392	9-23-63		

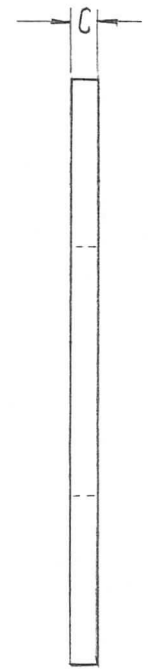
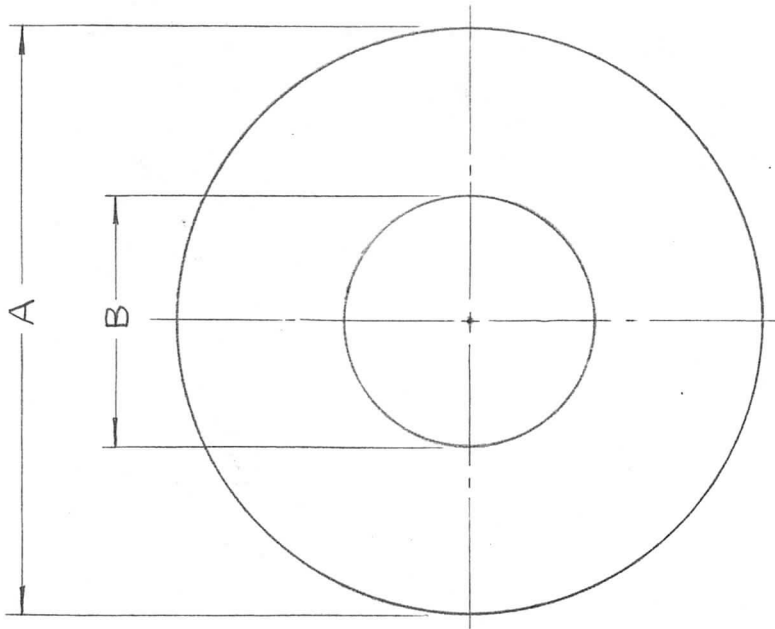

TMC NO.	A	B	C
PX-692-1	3.031	1.312	1/8
PX-692-2	6.062	1.562	7/16
PX-692-3	1.643	.460	1/4

SYM	DESCRIPTION	DATE	CH. NO.	DRAFTS	CHECKER	ENG. APP.	REQ. ITEM	PART NO.	FBUDETTI	DESCRIPTION	SYMBOL		
A	ADD - 3 TO CHART & TO TYPE & TEMPER TFE	9-20-66	16865	RME						THE TECHNICAL MATERIEL CORP. MAMARONECK. NEW YORK	PX-692   A		
Ø	ORIGINAL RELEASE FOR PRODUCTION	5/21/64	0	A.M.					STOCK SIZE				
XI	PX-692-2 ADDED	1-29-64							TEFLON				
									MATERIAL				
	UNLESS OTHERWISE SPECIFIED DIMENSIONS ARE IN INCHES AND INCLUDE CHEMICALLY APPLIED OR PLATED FINISHES	SCALE											
	DECIMALS .X ± .05 .XX ± .01 .XXX ± .005	FRACTIONS ± 1/64 ANGLES ± 0° 30'	CODE A							TFE	SRG	aa	RME
	TOLERANCES								TYPE & TEMPER	HEAT TREAT. SPEC.	DRAWN	CHECKED	FINAL APPROVAL
									NATURAL				
									FINISH & SPEC. NO.		ELEC. DES. APP.	MECH. DES. APP.	