

The TMC END SEAL ASSEMBLY, Model ES-85/U is an RF coaxial type fitting, similar to the TMC Connector-Adapter, Model TCA-85/12, and is used to seal off the ends of transmission line cables. The End Seal prevents moisture or humidified air from entering the antenna coupling boxes or the cable layers. The assembly also affords protection if the splice joints should leak, thereby preventing moisture from drawing into the cable layers. The assembly of the End Seal Assembly, Model ES-85/U to RG-85/U Cable is illustrated by exploded views on the reverse side of this bulletin.

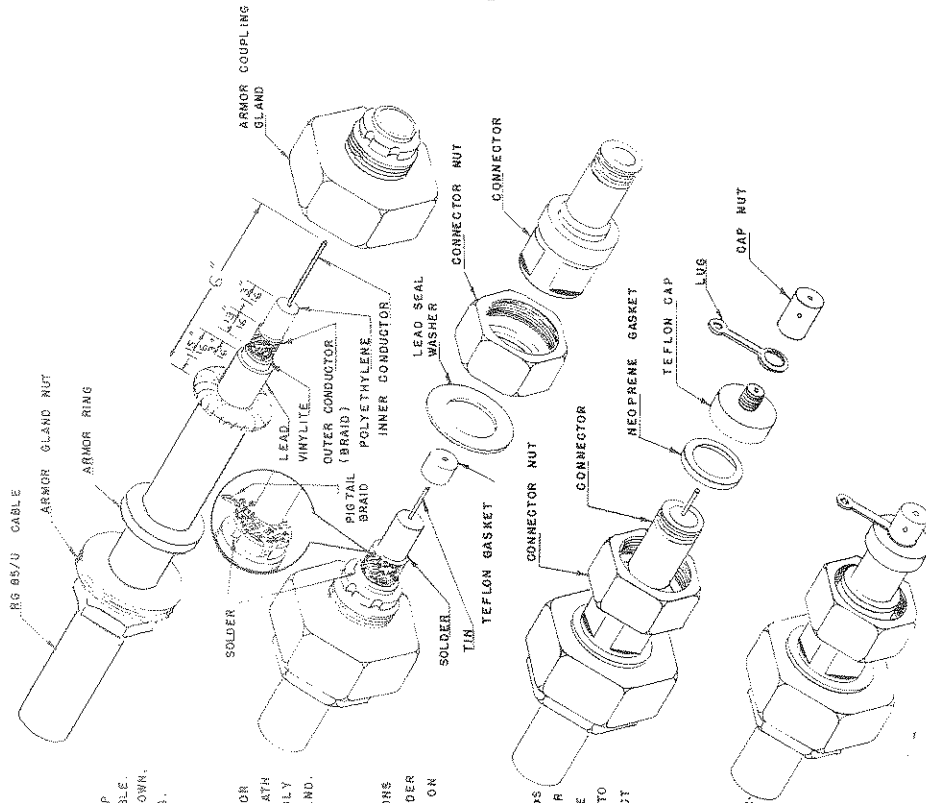

1. SQUARE OFF END OF RG85/U CABLE AND SLIP ARMOR GLAND NUT AND ARMOR RING OVER CABLE. BEND OUTSIDE ARMOR TO FORM FLARE AS SHOWN. ON DETAIL SKETCH. GRIND OFF ROUGH SPOTS.
2. ASSEMBLE THE ARMOR COUPLING GLAND, ARMOR RING, AND ARMOR GLAND NUT. CUT LEAD SHEATH TO EXTEND 1/16" LONGER THAN THE ASSEMBLY AND SOLDER TO THE ARMOR COUPLING GLAND.
3. DIVIDE THE COPPER BRAID INTO SIX SECTIONS AND TWIST EACH ONE INTO A PIG TAIL. SOLDER THE PIG TAILS TO THE GROOVES PROVIDED ON THE ARMOR COUPLING GLAND. TIN CENTER CONDUCTOR.
4. PLACE THE LEAD SEAL WASHER OVER THREADS OF THE COUPLING GLAND AND THE CONNECTOR NUT OVER THE CONNECTOR. MEASURE OFF THE POLYETHYLENE AND TRIM OFF SUFFICIENTLY TO ALLOW THE TEFLON GASKET TO PROJECT 1/16" FROM THE END OF CONNECTOR.
5. SCREW THE CONNECTOR WITH CONNECTOR NUT ATTACHED ON TO COUPLING GLAND. PLACE NEOPRENE GASKET OVER THE CONDUCTOR. SCREW THE TEFLON CAP WITH LUG AND CAP NUT ATTACHED TO THE CONNECTOR. SOLDER INNER CONDUCTOR TO CAP NUT AND CUT OFF EXCESS INNER CONDUCTOR.

NOTE:  
SEAL ALL THREADS WITH GLYPTOL

End Seal Assembly, ES-85/U

A-437-B

# THE TECHNICAL MATERIEL CORPORATION

700 FENIMORE ROAD

MAMARONECK, NEW YORK

CABLE  
TEPEI  
MAMARONECK, N.Y.

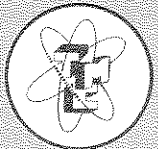

COMMUNICATION ENGINEERS

IN CANADA:  
TMC (CANADA) LTD.  
OTTAWA, ONTARIO