

IF IT IS FOUND DESIRABLE TO CHANGE ANY TOLERANCE OR OTHER DETAIL SPECIFIED ON THIS DRAWING NOTIFY THE PURCHASER PROMPTLY.

MAXIMUM ALLOWABLE TOLERANCES HAVE BEEN DETERMINED AND DEVIATIONS WILL BE CAUSE FOR REJECTION. REMOVE ALL BURRS AND SHARP EDGES

A-747

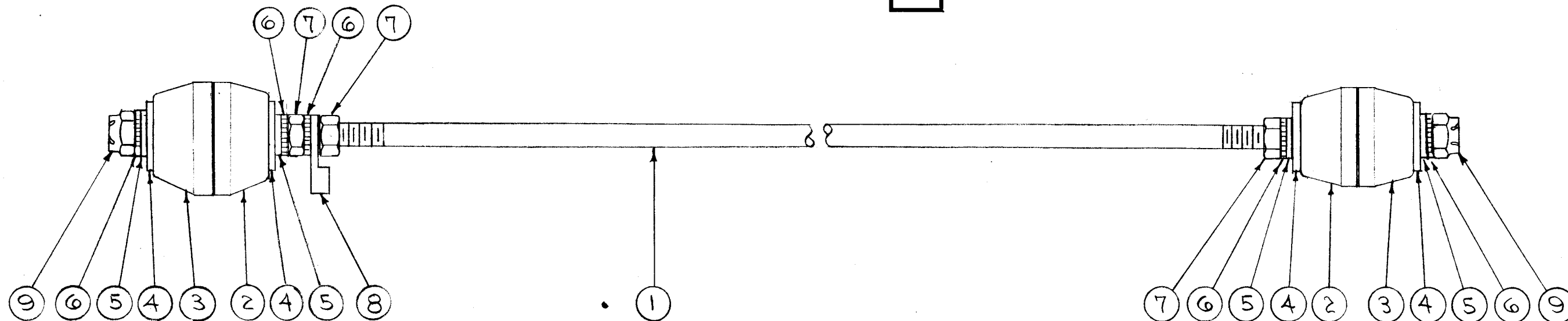

FOR PRODUCTION USE ONLY

2	9	SM-127-D-10-32	NUT, LOCK	
1	8	TE-141-3	TERMINAL	
3	7	NTH10328C12	NUT, HEX	
5	6	LWE10 MRC	WASHER, LOCK.	
4	5	FW 10 MRC	" , FLAT	
4	4	WA-106-1	WASHER, FIBER	
2	3	NS-112-2	INSULATOR	
2	2	NS-112-1	"	
1	1	PM-257	ROD, WIPER	
REQ.	ITEM	PART NO.	DESCRIPTION	SYMBOL
#			THE TECHNICAL MATERIEL CORP. MAMARONECK. NEW YORK	
STOCK SIZE				
#			WIPER ROD ASSEMBLY.	
#			TAC-1	
#			C.D.D.	
TYPE & TEMPER			DRAWN	
#			ELEC. DES. APP.	
HEAT TREAT. SPEC.			MECH. DES. APP.	
#			CHECKED	
FINISH & SPEC. NO.			FINAL APPROVAL	
			A-747	

ISSUE	ITEM	CHANGED FROM	DATE	CN. NO.	DRAFTS	CHECKER	ENG. APP.
Ø		ORIGINAL RELEASE	8/14/68				

TOLERANCES	SCALE:
ALL OTHERS DEC. DIM. ± FRAC. DIM. ± ANGULAR DIM. ±	DRILL, PUNCH, COMMERCIAL STOCK SIZES AND MANUFACTURERS TOLERANCES ARE NOT INCLUDED.

REG PER UNIT	MODEL	PROJECT NO.	ASS'Y. NO.	DATE
1	TAC-1	132		