

C
BB-120

THE CONTENTS OF THIS DRAWING ARE THE EXCLUSIVE PROPERTY OF THE TECHNICAL MATERIEL CORP. ITS UNAUTHORIZED USE OR REPRODUCTION IN WHOLE OR IN PART IS STRICTLY FORBIDDEN.

TMC PART NO.	MFRS REF	MFRS PART NUMBER	SYTLE SEE PICTORIAL	B BORE	DIMENSIONS D DIAMETER	W WIDTH	MIN RADIAL LOAD RATING AT 1,000 RPM (POUNDS)
BB120-1	A	77R4	I	+ .0000 .2500 - .0003	+ .0000 .6250 - .0004	+ .000 .1960 - .005	43
BB120-2	A	77R6	I	+ .0000 .3750 - .0003	+ .0000 .8750 - .0004	+ .000 .2812 - .005	112
BB120-3	A	77R8	I	+ .0000 .5000 - .0002	+ .0000 1.1250 - .0002	+ .000 .3125 - .005	215
BB120-4	A	77R12	I	+ .0000 .7500 - .0004	+ .0000 1.6250 - .0005	+ .000 .4375 - .005	425
BB120-5	B	S12 1/2RFF	I	+ .0000 1.3750 - .0005	+ .0000 2.5000 - .0005	+ .000 .5625 - .005	790
BB120-6	C	S8R	II	+ .0000 .7500 - .0004	+ .0000 1.6250 - .0005	+ .000 .3125 - .005	523/500 RPM

A109 3 REQ'D

AF109 1 REQ'D

STYLE I TWO SHIELDS	STYLE II PLAIN

SEE STYLE PICTORIAL

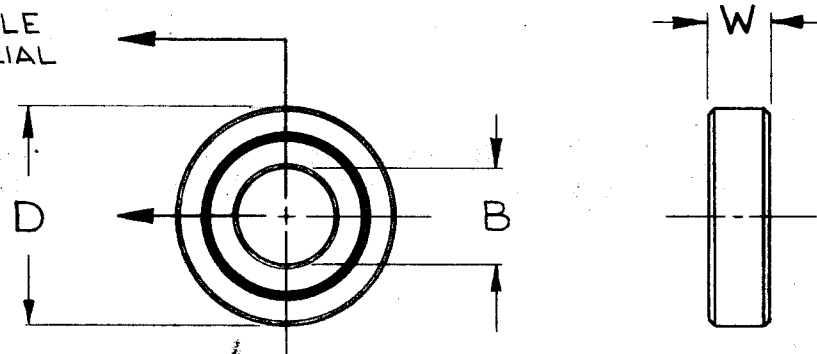

SPECIFICATIONS:

1. SINGLE ROW, RADIAL
2. STYLE - PER CHART

MFRS REF.	A=NEW DEPARTMENT B=FEDERAL BEARINGS C=NORMA HOFFMANN		
REQ. ITEM	PART NO.	DESCRIPTION	SYMBOL
		THE TECHNICAL MATERIEL CORP. MAMARONECK, NEW YORK	
	STOCK SIZE	BEARING, BALL	
	MATERIAL	SINGLE ROW, RADIAL	
TYPE & TEMPER	HEAT TREAT. SPEC.	DRAWN	CHECKED
		<i>R. Chas. H.</i> 7-10-63	<i>[Signature]</i>
FINISH & SPEC. NO.	ELEC. DES. APP.	MECH. DES. APP.	BB-120 C

C	ADD STYLE II	12-2-69	19670	KD	<i>[Signature]</i>	F.P.	<i>[Signature]</i>
B	REVISED & REDRAWN	7-10-63	9315	<i>[Signature]</i>	<i>[Signature]</i>	WB	<i>[Signature]</i>
SYM	DESCRIPTION	DATE	CH. NO.	DRAFTS	CHECKER	ENG. APP.	
UNLESS OTHERWISE SPECIFIED:		SCALE:					
DIMENSIONS ARE IN INCHES		MAXIMUM ALLOWABLE TOLERANCES HAVE BEEN DETERMINED AND ANY DEVIATIONS WILL BE CAUSE FOR REJECTION.					
TOLERANCES ON FRACTIONS ± 1/64		DECIMALS ± .005		ANGLES ± 1/2°		REMOVE ALL BURRS AND SHARP EDGES	
REQ. PER UNIT	MODEL	SECTION	ASS'Y. NO.	DATE	USED ON		