

BB-123

MFRS CAT NO.	A		B		LENGTH "C"	
	INSIDE DIA		OUTSIDE DIA			
	ACTUAL	NOM	ACTUAL	NOM		
BB-123-1	B1216-4	.753	3/4	1.003	1	1/2
BB-123-2	B1216-5					5/8
BB-123-3	B1216-6					3/4
BB-123-4	B1216-7					7/8
BB-123-5	B1216-8					1
BB-123-6	B1216-9					1 1/8
BB-123-7	B1216-10					1 1/4
BB-123-8	B1216-12					1 1/2
BB-123-9	B1216-14					1 3/4
BB-123-10	B1216-16					2
BB-123-11	B1216-20	.753	3/4	1.003	1	2 1/2
BB-123-12	B68-4	.377	3/8	.502	1/2	1 1/2
BB-123-13	B68-5	.377	3/8	.502	1/2	5/8
BB-123-14	B68-3	.377	3/8	.502	1/2	3/8
BB-123-15	B68-10	.377	3/8	.502	1/2	1 1/4
BB-123-16	B810-4	.502	1/2	.628	5/8	1/2
BB-123-17	B811-9	.502	1/2	.690	11/16	1 1/8
BB-123-18	B57-11	.314	5/16	.439	7/16	1 3/8
BB-123-19	B58-3	.314	5/16	.502	1/2	3/8
BB-123-20	B58-10	.314	5/16	.502	1/2	1 1/4
BB-123-21	B56-7	.314	5/16	.377	3/8	7/8
BB-123-22	B1418-6	.878	7/8	1.128	1 1/8	3/4
BB-123-23	SPECIAL B68	.377	3/8	.502	1/2	5/32
BB-123-24	SPECIAL B68	.377	3/8	.502	1/2	1/4
BB-123-25	B58-8	.314	5/16	.502	1/2	1
BB-123-26	B68-8	.377	3/8	.502	1/2	1
BB-123-27	SPECIAL	.189	3/16	.314	5/16	5/32
BB-123-28	SPECIAL	.627	5/8	.753	3/4	3/16

P/N	MFRS CAT NO.	A		B		LENGTH "C"	
		INSIDE DIA		OUTSIDE DIA			
		ACTUAL	NOM	ACTUAL	NOM		
	BB-123-29	SPECIAL	.187	3/16	.312	5/16	3/32
	BB-123-30	SPECIAL	.250	1/4	.375	3/8	3/32
	BB-123-31	B46-5	.252	1/4	.377	3/8	5/8
	BB-123-32	SPECIAL	.252	1/4	.502	7/2	3/16

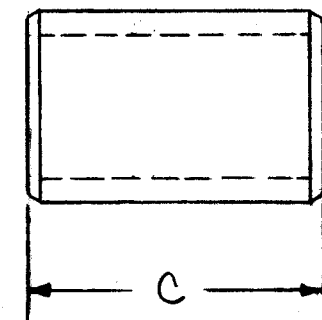
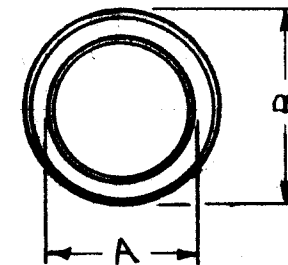

NOTICE TO PERSONS RECEIVING THIS DRAWING

THE TECHNICAL MATERIEL CORPORATION claims proprietary right in the material disclosed hereon. This drawing is issued in confidence for engineering information only and may not be reproduced or used to manufacture anything shown hereon without permission from THE TECHNICAL MATERIEL CORPORATION to the user. This drawing is loaned for mutual assistance and is subject to recall at any time.

Property of: _____

THE TECHNICAL MATERIEL CORPORATION
MAMARONECK, NEW YORK

G	1	BB-123-28	7.13.64	11701	15B	JCB	JCB	H	LINES BB-123-29, 30 ADDED	6.24.65	14339	D.V.V.	JCB	JCB
F	1	BB-123-27 ADDED	4-1-63	10124	15B	JCB	JCB	J	-31 ADD. ACTUAL WAS ACTUAL	12/6/61	15281	D.V.V.	JCB	JCB
E	1	BB-123-22 THRU 26 ADDED	6-18-63	9322	15B	JCB	JCB	K	-32 ADDED. PICT. RELOC.	11-21-64	17296	R.M.E.	JCB	JCB

D	4	LENGTH TOL REVISED												
	3	LENGTH TOL THRU 21 ADDED												
	2	ID "OD" TOL ADDED	6-12-63	9248	15B	JCB	JCB							
	1	A & B COLUMN ADDED												
C	1	BB-123-12 & -13 added	11/10/60	3519	15B	JCB	JCB							
B	2	LENGTH TOL WAS ±.005 A WAS .1.003 F.000 - .002	3-22-60		15B	JCB	JCB							
A	-	TOL. ADDED	3/17/60		15B	JCB	JCB							

TOLERANCES:
 ID & OD: UP TO 1", +.000 - .001
 1" TO 2", +.000 - .002.
 LENGTH: UP TO 1 1/2", ±.005
 1 1/2" TO 3", ±.008.

REF: BOSTON GEAR

REQ. ITEM	PART NO.	DESCRIPTION	SYMBOL
THE TECHNICAL MATERIEL CORP. MAMARONECK, NEW YORK			
BEARING, CYLINDRICAL OIL IMPREGNATED BRONZE			
MATERIAL		W.F. K	
TYPE & TEMPER		DRAWN	
HEAT TREAT. SPEC.		CHECKED	
FINISH & SPEC. NO.		FINAL APPROVAL	
ELEC. DES. APP.		MECH. DES. APP.	

DEC. DIM. ± SEE TOLERANCE NOTE
 FRAC. DIM. ±
 ANGULAR DIM. ±

SCALE: MAXIMUM ALLOWABLE TOLERANCES HAVE BEEN DETERMINED AND ANY DEVIATIONS WILL BE CAUSE FOR REJECTION. REMOVE ALL BURRS AND SHARP EDGES

REQ. PER UNIT	MODEL	PROJECT NO.	ASS'Y. NO.	DATE
		GPT-40K		2-16-60
USED ON				

BB-123 K