

ISSUE	ITEM	CHANGED FROM	DATE	CN. NO.	DRAFTS	CHECKER	ENG. APP.	REQ.	ITEM	PART NO.	DESCRIPTION	SYMBOL
Ø		PROD RELEASE	22 AUG 70		AS							
AMC EB		074/70		22 AUG 70		DATE		ABB'Y. NO.		TMC (Canada) LIMITED OTTAWA ONTARIO		
MODEL		PROJECT NO.		USED ON		STOCK SIZE		MATERIAL		CORE TORROIDAL		
MAXIMUM ALLOWABLE TOLERANCES HAVE BEEN DETERMINED AND DEVIATIONS WILL BE CAUSE FOR REJECTION. REMOVE ALL BURRS AND SHARP EDGES		IF IT IS FOUND DESIRABLE TO CHANGE ANY TOLERANCE OR OTHER DETAIL SPECIFIED ON THIS DRAWING NOTIFY THE PURCHASER PROMPTLY.		SCALE 1:1		WEIGHT PER PC.		TYPE & TEMPER		DRAWN BY SHAPSON		
TOLERANCES		DEC. DIM. ± .015		DIMENSIONS IN INCHES UNLESS OTHERWISE SPECIFIED		HEAT TREAT. SPEC.		ELEC. DES. APP.		MECH. DES. APP.		
ALL OTHERS		FRAC. DIM. ± 1/64		DRILL: PUNCH, COMMERCIAL STOCK SIZES AND MANUFACTURERS TOLERANCES ARE NOT INCLUDED.		FINISH & SPEC. NO.		CHECKED		FINAL APPROVAL		
		ANGULAR DIM. ± 0° 30'		.XXX-005				CI 10012-T-68-2 - RCA		Ø		

BARBOT

ISSUE	ITEM	CHANGED FROM	DATE	CM. NO.	DRAFTS	CHECKER	ENG. APP.	REQ.	ITEM	PART NO.
0		RELEASED TO RECDN	25/10		JB	[Signature]	Ka14			

MANUFACTURER'S PART N ^o	Q/D	I/D	HEIGHT	L	100 TURNS	TEST FREQ	COLOUR CODE
T44-10	0.440	0.229	0.159	48 μH	18 MHZ	BLACK	
T68-2	0.690	0.370	0.190	115 μH	450 KHZ	RED	

PERMEABILITY TOLERANCE ± 2%

CI 10012 - T44-10

BASIC TMC N^o

MANFR'S PART N^o

STANDARD DRAWING

MANUFACTURER SA01-307

TMC (Canada) LIMITED
OTTAWA
ONTARIO

CORE, TORONTO

MODEL	PROJECT NO.	ASSY. NO.	DATE
USED ON			
MAXIMUM ALLOWABLE TOLERANCES HAVE BEEN DETERMINED AND DEVIATIONS WILL BE CAUSE FOR REJECTION. REMOVE ALL BURRS AND SHARP EDGES		IF IT IS FOUND DESIRABLE TO CHANGE ANY TOLERANCE OR OTHER DETAIL SPECIFIED ON THIS DRAWING NOTIFY THE PURCHASER PROMPTLY.	
TOLERANCES			
DEC. DIM. ±	.X = .05	SCALE	
FRACTIONAL DIM. ±	.XX = .01	DIMENSIONS IN INCHES	
ANGULAR DIM. ±	.XXX = .005	UNLESS OTHERWISE SPECIFIED	
ALL OTHERS		DRILL: PUNCH, COMMERCIAL STOCK SIZES AND MANUFACTURERS TOLERANCES ARE NOT INCLUDED.	
STOCK SIZE		WEIGHT PER PC.	
MATERIAL		TYPE & TEMPER	
HEAT TREAT. SPEC.		FINISH & SPEC. NO.	
DRAWN		CHECKED	
ELEC. DES. APP.		FINAL APPROVAL	
SPEC. DES. APP.		CI 10012	

BARTLETT

Ka14

[Signature]

[Signature]

CI 10012

ISSUE	ITEM	CHANGED FROM	DATE	CN. NO.	DRAFTS	CHECKER	ENS. APP.	REQ.	ITEM	PART NO.	DESCRIPTION	SYMBOL
∅		PROD RELEASE	26 AUG 70		<i>[Signature]</i>							

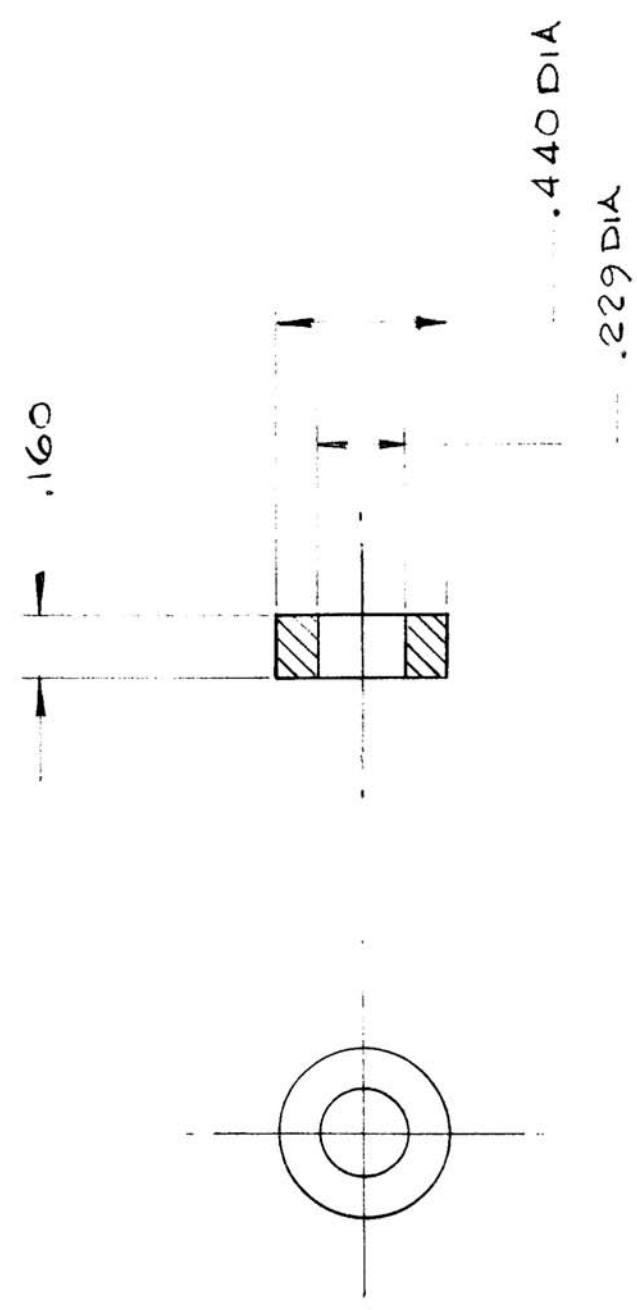

AMC-B	074/70	26 AUG 70									TMC (Canada) LIMITED OTTAWA ONTARIO	
MODEL		PROJECT NO.	DATE	USED ON		STOCK SIZE		FERRITE		CORE TOROIDAL		
MAXIMUM ALLOWABLE TOLERANCES HAVE BEEN DETERMINED AND DEVIATIONS WILL BE CAUSE FOR REJECTION REMOVE ALL BURRS AND SHARP EDGES		IF IT IS FOUND DESIRABLE TO CHANGE ANY TOLERANCE OR OTHER DETAIL SPECIFIED ON THIS DRAWING NOTIFY THE PURCHASER PROMPTLY.		SCALE 2:1		MATERIAL		TYPE & TEMPER		DRAWN <i>[Signature]</i>		
TOLERANCES		DIMENSIONS IN INCHES UNLESS OTHERWISE SPECIFIED		HEAT TREAT. SPEC.		WEIGHT PER PC.		CHECKED		ELEC. DES. APP. <i>[Signature]</i> MECH. DES. APP. <i>[Signature]</i>		
DEC. DIM. ± 0.015	FRAC. DIM. ± 1/64	ANGULAR DIM. ± 0° 30'	DRILL: PUNCH, COMMERCIAL STOCK SIZES AND MANUFACTURERS TOLERANCES ARE NOT INCLUDED.		FINISH & SPEC. NO.		FINAL APPROVAL		CI 10012-T44-10-RCA ∅			
ALL OTHERS												