

| ISSUE | ITEM | CHANGED FROM | DATE | CM NO. | DRAFTS | CHECKER | ENG. APP. | REQ | ITEM | PART NO. | DESCRIPTION | SYMBOL |
|-------|------|--------------|-----------|--------|--------|---------|-----------|-----|------|----------|-------------|--------|
| 0 | | PROD RELEASE | 12 MAR 73 | | C.C. | | | | | | | |

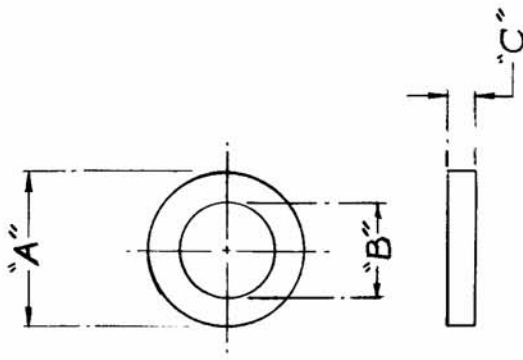

| TMC PART NO. | MANUFACTURER'S PART NO. | A | B | C |
|--------------|-------------------------|-------|-------|------|
| CI 10015-1 | CF-118 | .080 | .050 | .025 |
| CI 10015-2 | CF-119 | .100 | .070 | .030 |
| CI 10015-3 | CF-120 | .155 | .088 | .051 |
| CI 10015-4 | CF-101 | .230 | .120 | .060 |
| CI 10015-5 | CF-121 | .300 | .125 | .188 |
| CI 10015-6 | CF-102 | .375 | .187 | .125 |
| CI 10015-7 | CF-108 | .500 | .312 | .250 |
| CI 10015-8 | CF-111 | .870 | .540 | .250 |
| CI 10015-9 | CF-122 | 1.000 | .500 | .250 |
| CI 10015-10 | CF-114 | 1.250 | .750 | .375 |
| CI 10015-11 | CF-117 | 1.875 | 1.375 | .375 |
| CI 10015-12 | CF-123 | 2.400 | 1.400 | .500 |
| CI 10015-13 | CF-124 | 3.500 | 2.000 | .500 |
| CI 10015-14 | CF-125 | 5.810 | 2.500 | .625 |

MANUFACTURER: INDIANA GENERAL

| | | | | |
|--|-------------------------------|--|------------------------|--------------------------------|
| STANDARD | PROJECT NO. | DATE | 12 MAR 73 | TMC (Canada) LIMITED OTTAWA |
| MODEL | ASBY. NO. | USED ON | | TORCID |
| <p>MAXIMUM ALLOWABLE TOLERANCES HAVE BEEN DETERMINED AND DEVIATIONS WILL BE CAUSE FOR REJECTION REMOVE ALL BURRS AND SHARP EDGES</p> | | <p>IF IT IS FOUND DESIRABLE TO CHANGE ANY TOLERANCE OR OTHER DETAIL SPECIFIED ON THIS DRAWING NOTIFY THE PURCHASER PROMPTLY.</p> | | |
| <p>TOLERANCES</p> <p>DEC DIM. ± .005 FRAC. DIM. ± 1/64 ANGULAR DIM. ± 0'30"</p> | | <p>SCALE</p> <p>DIMENSIONS IN INCHES UNLESS OTHERWISE SPECIFIED</p> <p>DRILL: PUNCH, COMMERCIAL STOCK SIZES AND MANUFACTURERS TOLERANCES ARE NOT INCLUDED.</p> | | |
| ALL OTHERS | <p>STOCK SIZE</p> | | <p>MATERIAL</p> | |
| | <p>TYPE & TEMPER</p> | | <p>WEIGHT PER PC.</p> | |
| | <p>HEAT TREAT. SPEC.</p> | | <p>ELEC. DES. APP.</p> | |
| | <p>FINISH & SPEC. NO.</p> | | <p>MECH. DES. APP.</p> | |
| | <p>DRAWN</p> | | <p>CHECKED</p> | |
| | <p>FINAL APPROVAL</p> | | <p>CI 10015</p> | |