

REVISIONS						
ZONE	SYM	DESCRIPTION	DATE	E.M.N. NO.	DRAFT	CHKD
Ø		ORIGINAL RELEASE FOR PRODUCTION	6/1/65			HLA

THE TECHNICAL MATERIEL CORP.
MAMARONECK, NEW YORK
MODEL ARCD-1 CK 994

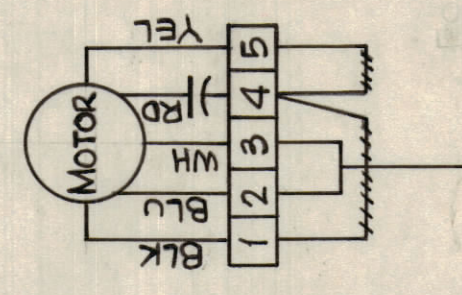
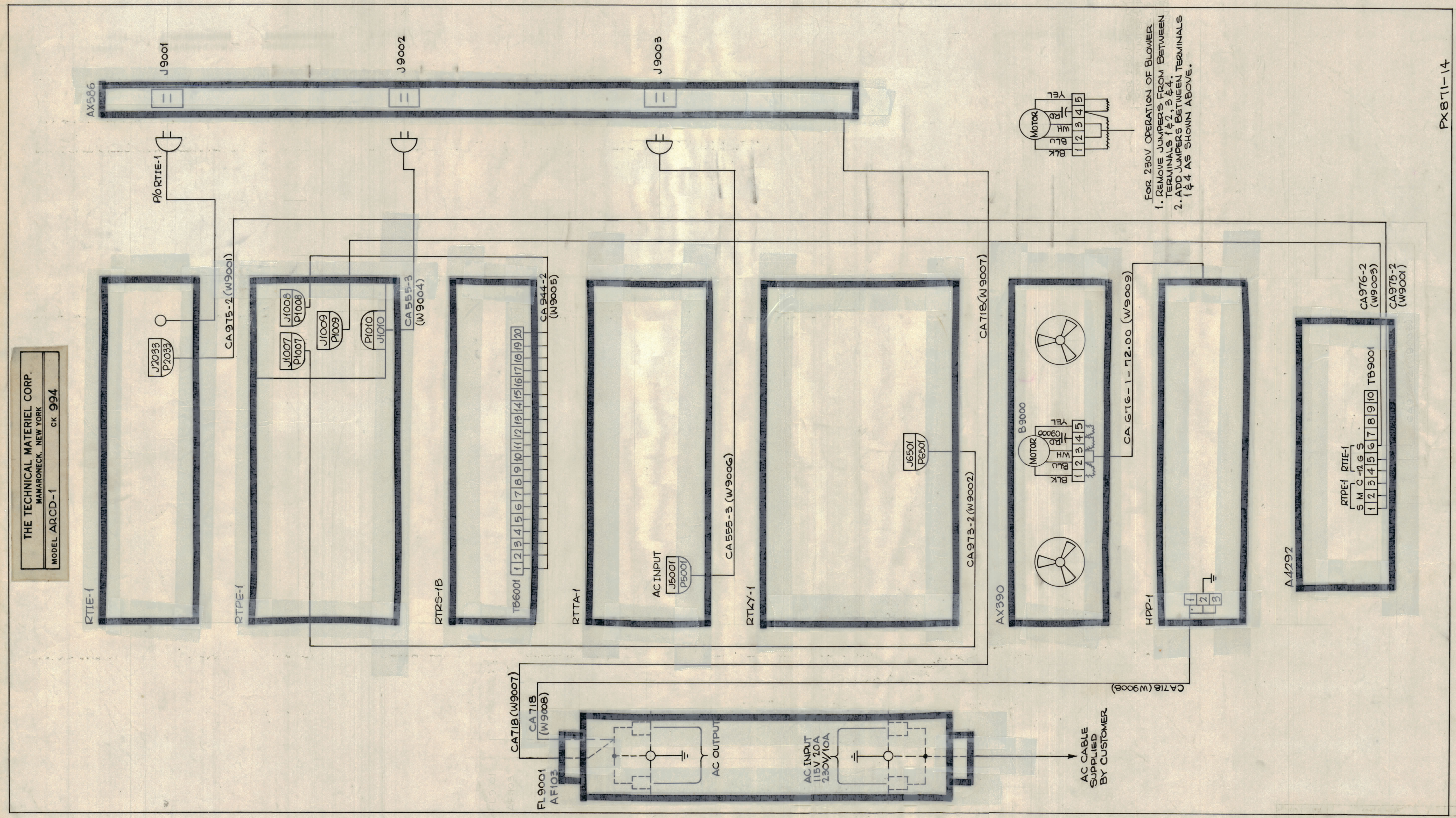

FOR 230V OPERATION OF BLOWER:
1. REMOVE JUMPERS FROM BETWEEN TERMINALS 1 & 2, 3 & 4.
2. ADD JUMPERS BETWEEN TERMINALS 1 & 4 AS SHOWN ABOVE.

REDUCE TO 10 1/2"

FOR LAMINATION DETAILS REFER TO PX871-14

NOTES

QTY./UNIT	MODEL USED ON	ASSY. NO.
SCALE	CODE	

MATERIAL FOR LAMINATING REFER TO PX871		THE TECHNICAL MATERIEL CORP. MAMARONECK, NEW YORK	
FINISH	TITLE	DATE	DATE
	WIRING DIAGRAM ARCD-1	5-28-65	6/1/65
CHECKED	DRAWN	DATE	DATE
		6/1/65	6/1/65
ELECT. DES.	DATE	CK994	Ø
MECH. DES.	DATE		
UNLESS OTHERWISE SPECIFIED DIMENSIONS ARE IN INCHES AND INCLUDE CHEMICALLY APPLIED OR PLATED FINISHES		REV. LTR.	
DECIMALS	FRACTIONS	SHEET	
X ± .05	± 1/64	1	
XX ± .01	ANGLES ± 0' 30"	REPROVAL NO. 4401	
XXX ± .005			

Ø 466 CK994

PX871-14