

IF IT IS FOUND DESIRABLE TO CHANGE ANY TOLERANCE OR OTHER DETAIL SPECIFIED ON THIS DRAWING NOTIFY THE PURCHASER PROMPTLY.		DIMENSIONS IN INCHES UNLESS OTHERWISE SPECIFIED					
MAXIMUM ALLOWABLE TOLERANCES HAVE BEEN DETERMINED AND DEVIATIONS WILL BE CAUSE FOR REJECTION. REMOVE ALL BURRS AND SHARP EDGES.							
ISSUE	ITEM	CHANGED FROM	DATE	CN. NO.	DRAFTS	CHECKER	ENG. APP.
Ø		REL. FOR PROD.	AUG. 19/69		W.P.		
A		REVISED PER CEMN	OCT 4/69	577	FW		
B		REVISED PER CEMN	OCT 14/69	590	FW		
C		REVISED PER CEMN	OCT 18/69	603	FW		
D		REVISED PER CEMN	OCT 23/69	605	FW		

ISSUE	ITEM	CHANGED FROM	DATE	CAL. NO.	DRAFTS	CHECKER	ENG. APP.
E		REV. PER CEMN.	25 JUN 71	1021	NAT.		
F		REV PER CEMN	JULY 7/71	1032	NAT.		
G		REV PER CEMN	OCT 14/71	1072	NAT.		

REQ.	ITEM	PART NO.	DESCRIPTION	SYMBOL
4	I	NT 10004-4	FLOATING CLINCH FASTENER	C

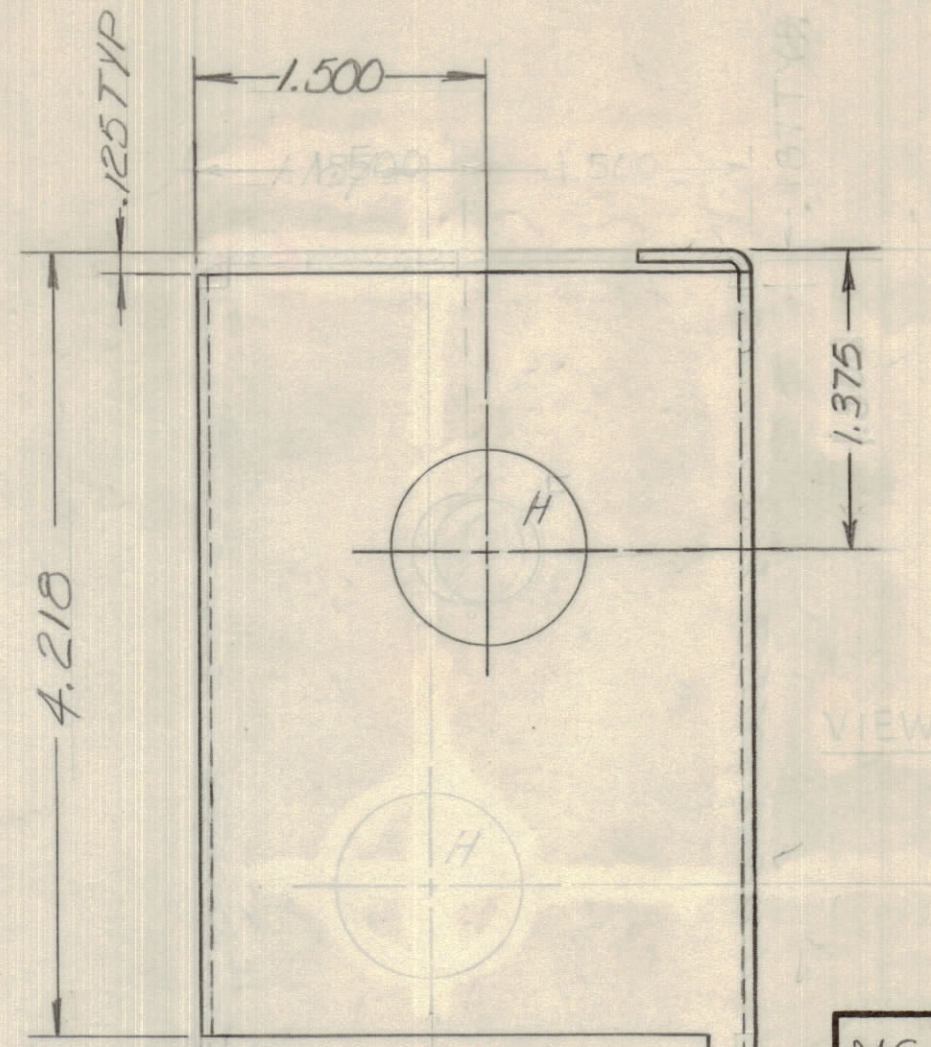
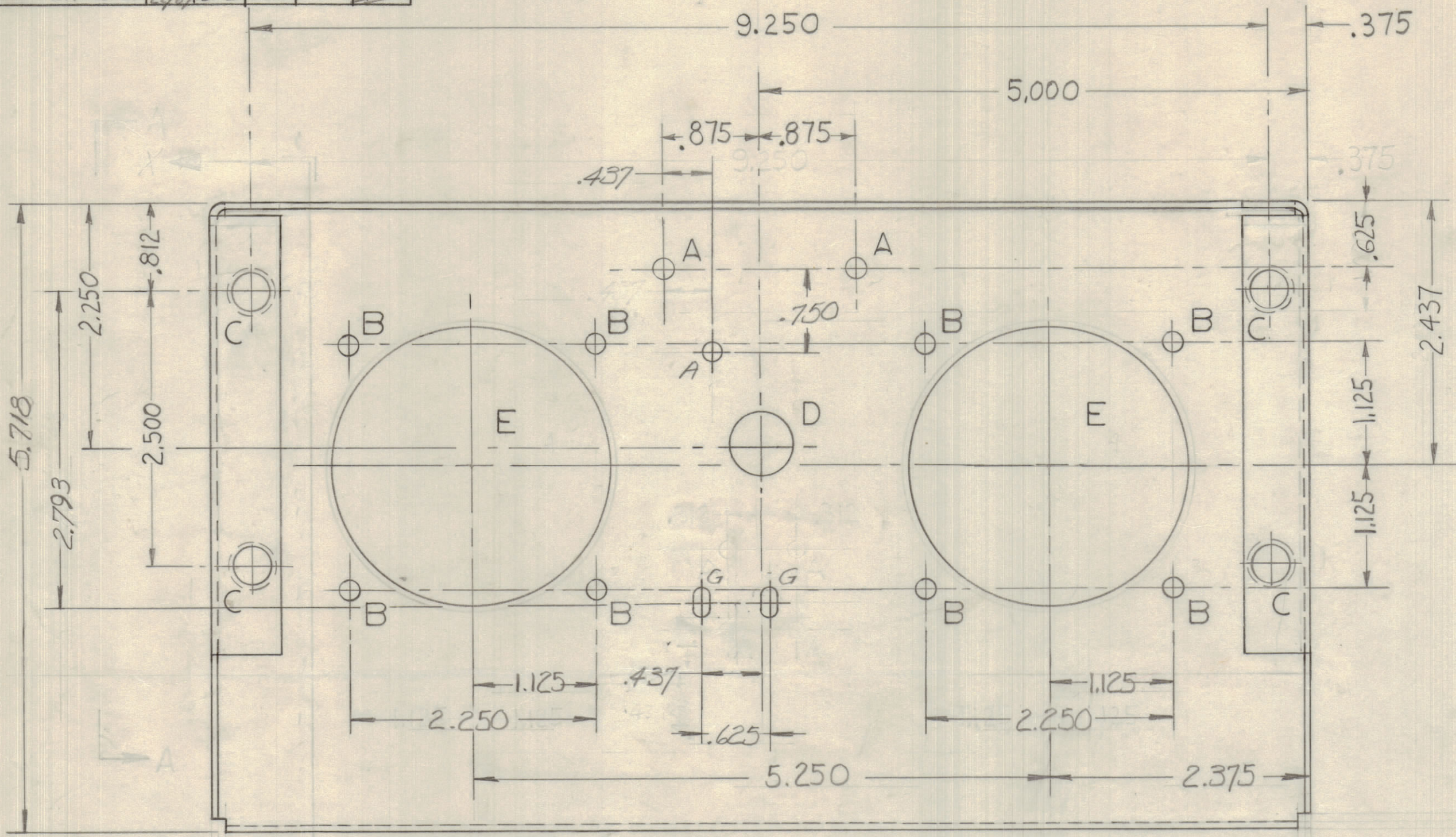

MS 11048 G

HOLE	DESCRIPTION	QTY
A	.159 DIA	6
B	.185 DIA	8
C	.328/.331 DIA	4
D	.531 DIA	1
E	2.500 DIA	2
F		
G	OBROUND .281 X .140	2
H	1.000 DIA	1

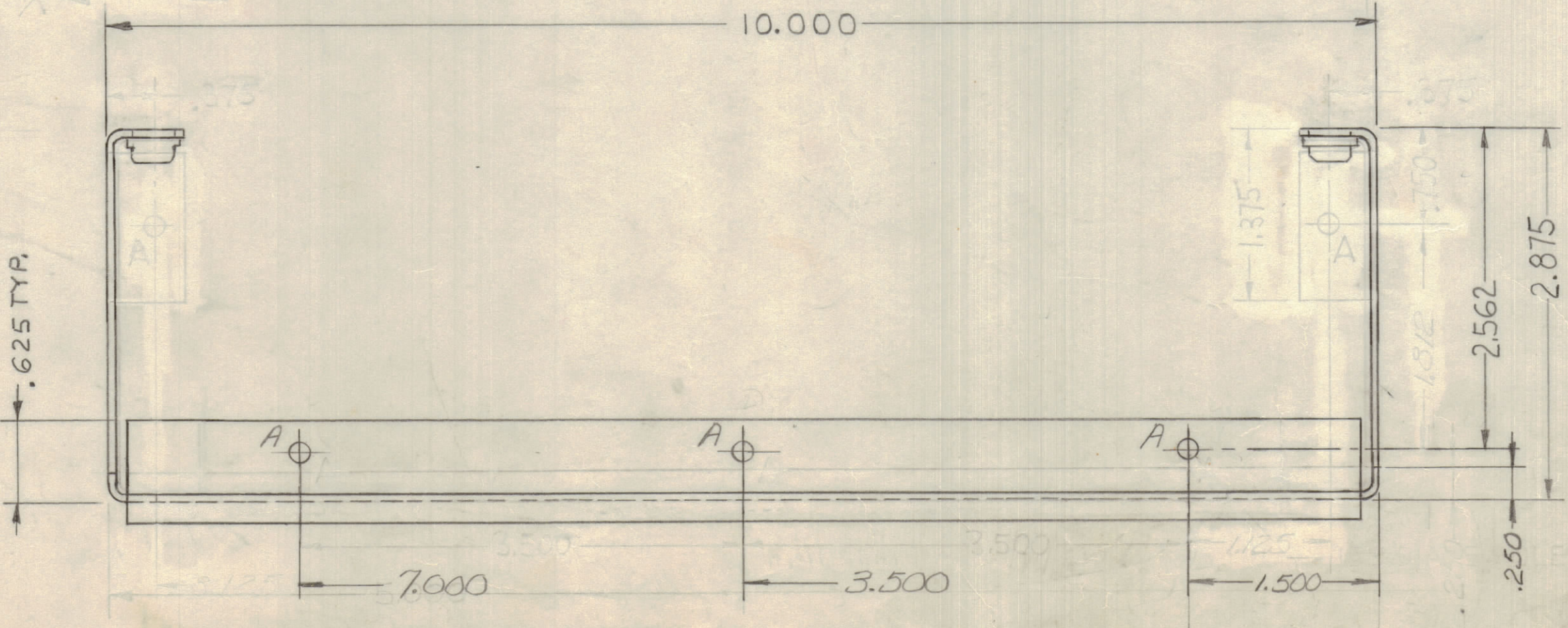

MINIMUM INSIDE BEND RADIUS, .062

METAL STAMP TMC PART NO. 1/8 HIGH, GOTHIC.

REF: LD10352

.062		TMC (Canada) LIMITED	
STOCK SIZE		OTTAWA ONTARIO	
AL/ALLOY		REAR PART CHASSIS RF	
MATERIAL		W. PIETZ	
575-H32		DRAWN	
TYPE & TEMPER		ELEC. DES. APP.	
HEAT TREAT. SPEC.		MECH. DES. APP.	
IRIDITE S-404		CHECKED	
FINISH & SPEC. NO.		FINAL APPROVAL	
		MS 11048 G	

LPA-1	088-69	AUG 11-69
MODEL	PROJECT NO.	DATE

TOLERANCES		SCALE:	1:1
ALL OTHERS	DEC. DIM. ± .005	DRILL, PUNCH, COMMERCIAL STOCK	
	FRAC. DIM. ± 1/64	SIZES AND MANUFACTURERS	
	ANGULAR DIM. ± 0° 30'	TOLERANCES ARE NOT INCLUDED.	