

REVISIONS							
ZONE	SYM	DESCRIPTION	DATE	E.M.N. NO.	DRAFT	CHKD	APPD

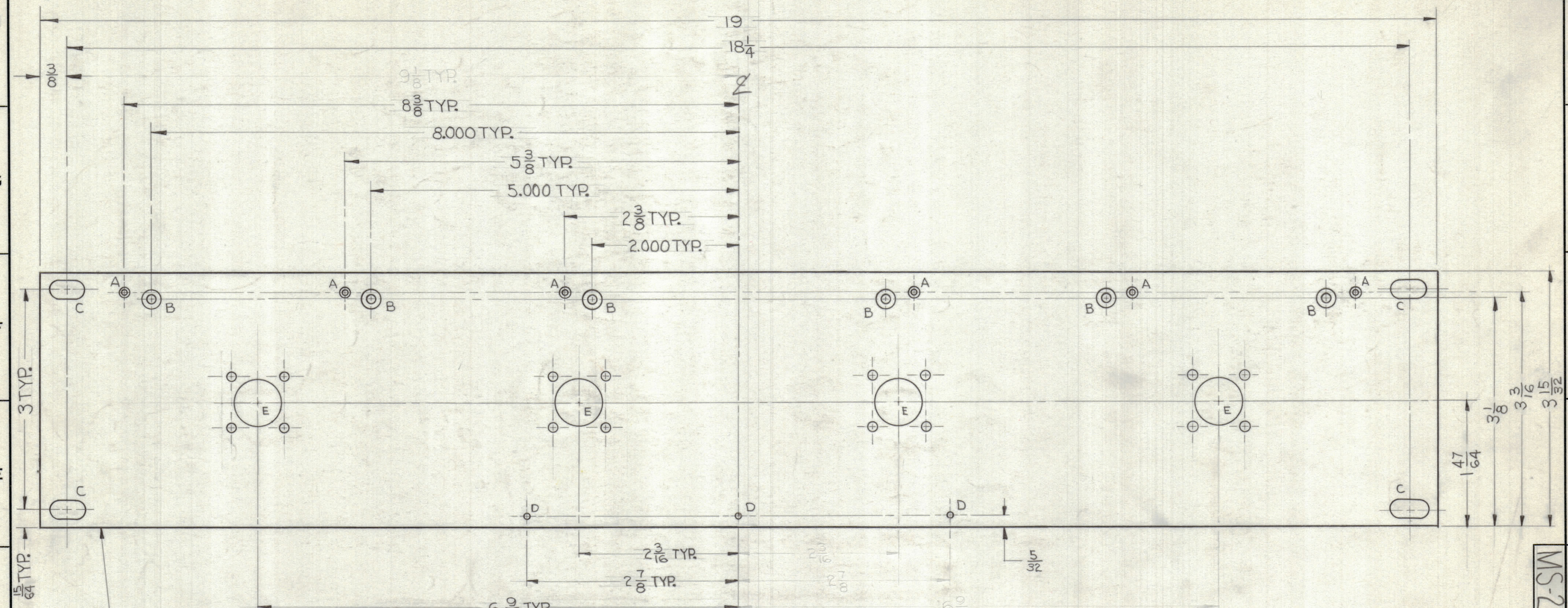

METAL STAMP TMC PART NO.
1/8 HIGH BLACK GOTHIC ON
REAR OF PANEL.

FRONT OF PANEL SHOWN

FINISHING NOTES:
S404 IRIDITE
S114 ZINC CHROMATE PRIMER
S115 TMC SMOOTH GREY ENAMEL
OR PRIME & PAINT TO CUST. SPEC.

FRONT &
EDGES ONLY

MACHINING NOTES:
1- LATERAL BOW OF PANEL MUST BE KEPT .031 TOL.
2- MILL ALL EDGES.
3- HOLES MUST BE DRILLED.
4- HOLES MUST BE FREE OF ALL MACHINING MARKS,
GOUGES & SCRATCHES. IF NECESSARY, SAND FRONT
OF PANEL WITH NO. 120 GRIT SANDPAPER.

E DETAIL

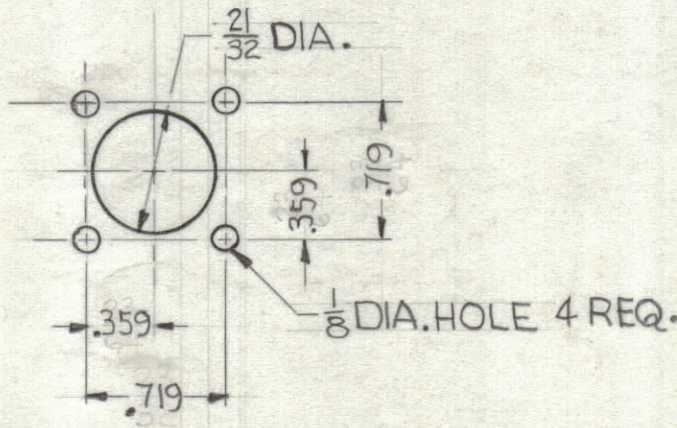

C'SINK DETAIL

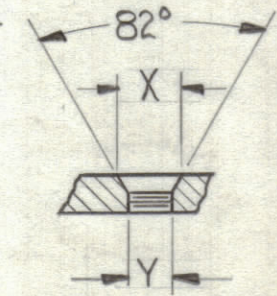

HOLE	TYPE	X	Y
A	3-48	.204	DRILL & TAP 3-48
B	6-32	.284	.144

HOLE	DESCRIPTION	REQ.
A	SEE DETAIL C'SINK	6
B	SEE DETAIL C'SINK	6
C	29/64 x 1/4 SLOT	4
D	.0785 DIA.	3
E	SEE DETAIL	4

REQ'D.	ITEM	PART NUMBER	DESCRIPTION	SYMBOL
PRITCHARD LIST OF MATERIAL				
MATERIAL		3/16 ALUMINUM 2024 T3		
FINISH		SEE FINISHING NOTES		
DRAWN		R. Juchin		
CHECKED		DATE 5/21/62		
ELECT. DES.		DATE 5/25/62		
MECH. DES.		DATE 5/25/62		
TOLERANCES		DECIMALS: .XX ± .01, .XXX ± .005; FRACTIONS: ± 1/64, ANGLES: ± 0° 30'		
TITLE		PANEL FRONT MACHINING		
THE TECHNICAL MATERIEL CORP.		MAMARONECK, NEW YORK		
DATE		5/21/62		
DATE		5/25/62		
DATE		5/25/62		
SHEET		MS-2987		
REV. LTR.				

NOTES

THE CONTENTS OF THIS DRAWING ARE THE EXCLUSIVE PROPERTY OF THE TECHNICAL MATERIEL CORP. ITS UNAUTHORIZED USE OR REPRODUCTION IN WHOLE OR IN PART IS STRICTLY FORBIDDEN.

MS-2987