

REVISIONS						
ZONE	SYM	DESCRIPTION	DATE	E.M.N. NO.	DRAFT	CHKD
X		EXP. RELEASE	10-3-64	X	JL	
X <sub>1</sub>		CUTOUTS ADDED, D HOLES WERE 1/32, RELOCATED; F HOLES ADDED, E HOLES WERE .093 D.	10-12-64	X <sub>1</sub>	SRG	W.J.
X <sub>2</sub>		.687 X 1 5/16 CUTOUT WAS .625 X 1 1/4; .687 X 6 5/16 CUTOUT WAS .625 X 6 1/4; 1 29/32 DIM. WAS 1 7/8; 7/8" D" HOLE MTG DIM. WAS 1 3/16; 13/32 DIM. WAS 7/16.	11/25/64		JL	W.J.
D		ORIGINAL RELEASE FOR PRODUCTION.	11-12-65		RF	

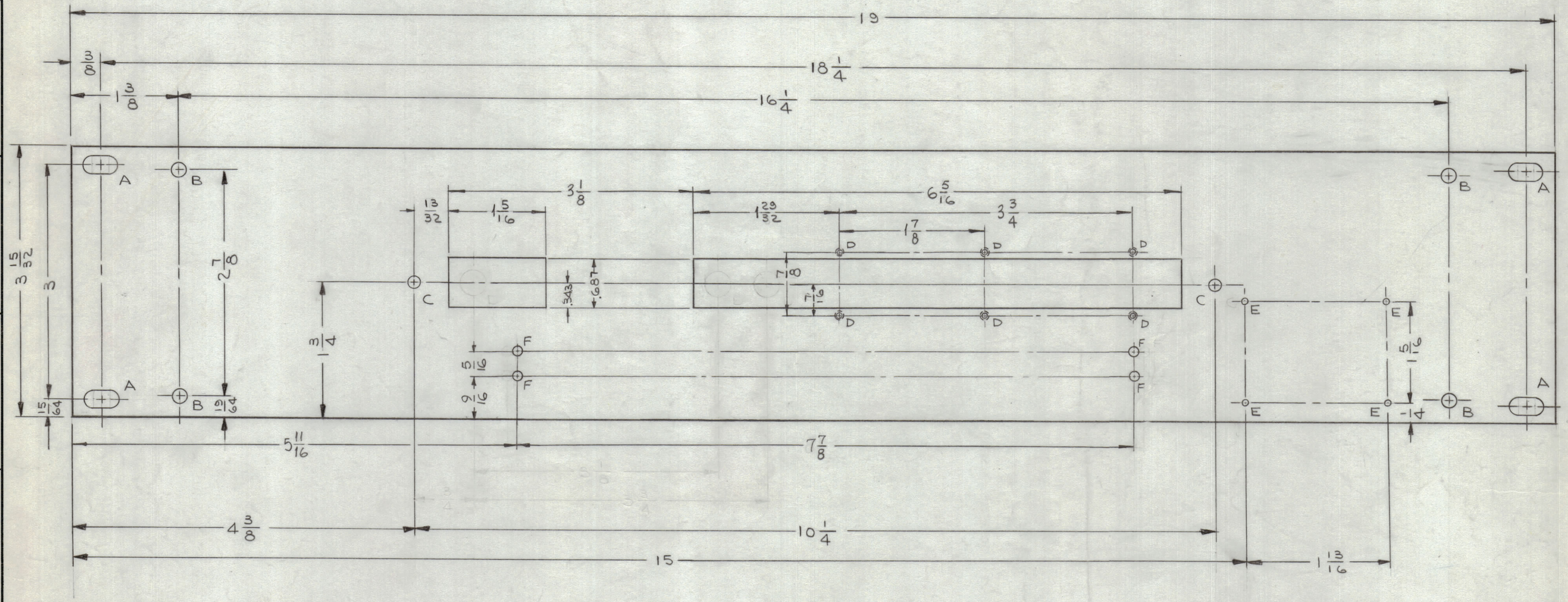

HOLE LEGEND		
HOLE	DESCRIPTION	REQ'D
A	SEE DETAIL	4
B	13/64 DIA	4
C	11/64 DIA	2
D	NO. 50 (.0700) DRILL & TAP 2-56-NC-2B	6
E	NO. 48 (.0760) DRILL	4
F	.118 DIA.	4

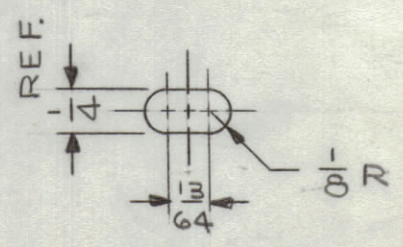

DETAIL A-

**MACHINING:**

1. MILL ALL EDGES.
2. HOLES MUST BE DRILLED, UNLESS OTHERWISE SPECIFIED.
3. LATERAL BOW OF PANEL MUST BE KEPT TO .031 TOLERANCE.
4. PANEL MUST BE FREE OF ALL MACHINING MARKS, GOUGES AND SCRATCHES. IF NECESSARY, SAND FRONT OF PANEL WITH NO. 120 GRIT SANDPAPER.

**FINISH NOTES:**

1. S404 - IRIDITE 14-2 AL-COAT.
2. S114 - ZINC CHROMATE PRIMER) FRONT AND
3. S115 - SMOOTH GRAY ENAMEL ) EDGES ONLY

**NOTES**

1	RTRS-1	
Q'TY./UNIT	MODEL USED ON	ASS'Y. NO.
SCALE	CODE	
1:1		

THE CONTENTS OF THIS DRAWING ARE THE EXCLUSIVE PROPERTY OF THE TECHNICAL MATERIEL CORP. ITS UNAUTHORIZED USE OR REPRODUCTION IN WHOLE OR IN PART IS STRICTLY FORBIDDEN.

REF. LD1599

REQ'D.	ITEM	PART NUMBER	DESCRIPTION	SYMBOL
<b>LIST OF MATERIAL</b>				
MATERIAL		THE TECHNICAL MATERIEL CORP.		
3/16 THK ALUMINUM		MAMARONECK, NEW YORK		
2024-T3				
FINISH		TITLE		
SEE NOTES		PANEL, FRONT		
UNLESS OTHERWISE SPECIFIED DIMENSIONS ARE IN INCHES AND INCLUDE CHEMICALLY APPLIED OR PLATED FINISHES		DRAWN	DATE	FINAL APPROVAL
		J. LESHINSKI	8/5/64	RF
		CHECKED	DATE	
DECIMALS		ELECT. DES.		DATE
.X ± .05		W. JORDAN		11/12/65
.XX ± .01				
.XXX ± .005		MECH. DES.		DATE
				11/12/65
				SHEET
				MS4020
				REV. LTR.

MS4020