

REVISIONS							
ZONE	LTR	DESCRIPTION	DATE	E.M.N.NO	DRAFT	CHKD	APPD
	X	EXP. RELEASE	9-20-67				
		ORIGINAL RELEASE FOR PRODUCTION	2-19-69		RG		

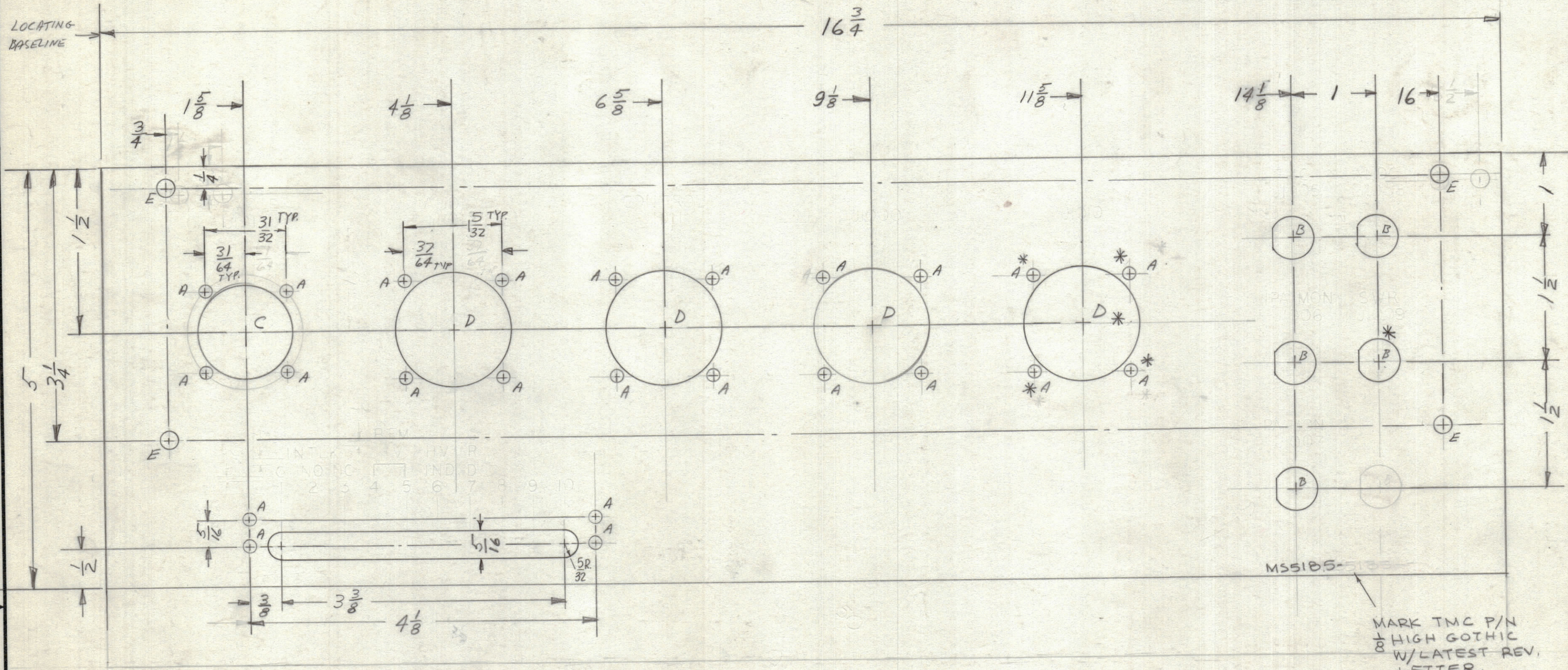

- A ~ 9/64 DIA 24 REQ
- B ~ SEE DETAIL 6 REQ.
- C ~ 1/16 DIA 1 REQ.
- D ~ 1 5/16 DIA. 4 REQ.
- E ~ 13/64 DIA 4 REQ.

TMC P/N	DESCRIPTION	MODEL
MS5185-1	AS SHOWN	GPT-10KRL, GPT-40KEL
*MS5185-2	EXCLUDE HOLES WITH *	GPT-10KLFE

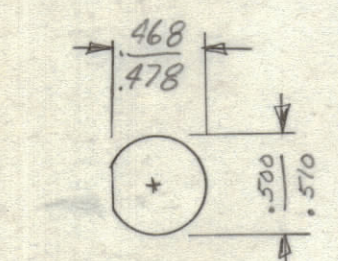

LD2250-GPT10KLFE  
REF: LD2249-GPT10KRL, GPT40KEL

QTY. REQ.	ITEM	PART NO.	DESCRIPTION	SYMBOL
LIST OF MATERIAL				
THE TECHNICAL MATERIEL CORP. MAMARONECK, NEW YORK				
PANEL, INTERFACE				
FINAL APPROVAL <i>BUDETTI</i>		DATE 2-18-69	PANEL, INTERFACE	
MECH. DES.		DATE 2-17-69		
ELECT. DES.		DATE		
CHECKED <i>SG</i>		DATE 5-20-67		
DRAWN <i>SM</i>		DATE 11 Sep 67	SIZE	ISSUE
MATERIAL 1/8 ALUMINUM 2024-T3		FINISH 509 Yel Inl.	CODE IDENT. NO. C 82679	DWG NO. MS5185-100
SCALE			SHEET	OF

QTY / UNIT	MODEL USED ON	ASS'Y NO.
1	GPT-10KLFE	
1	GPT-40KEL	
1	GPT-10KRL	

APPLICATION	
CODE	S401-431
A	

NOTICE TO PERSONS RECEIVING THIS DRAWING  
THE TECHNICAL MATERIEL CORPORATION claims proprietary right in the material disclosed hereon. This drawing is issued in confidence for engineering information only and may not be reproduced or used to manufacture anything shown hereon without permission from THE TECHNICAL MATERIEL CORPORATION to the user. This drawing is loaned for mutual assistance and is subject to recall at any time.