

REQ. PER UNIT	USED ON			PL 201	Ø
	MODEL	ASS'Y. NO.	DATE		

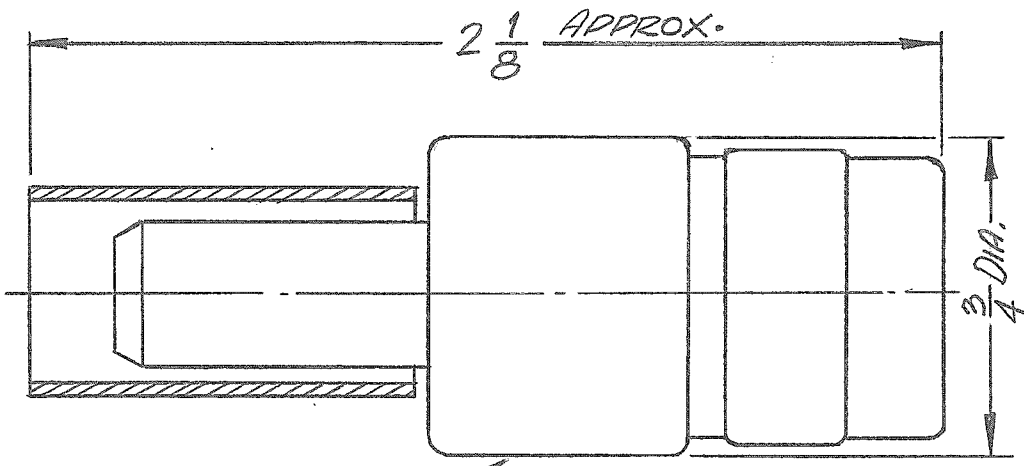

STAMP TMC P/N PL201

CABLE STRIP DIMENSIONS

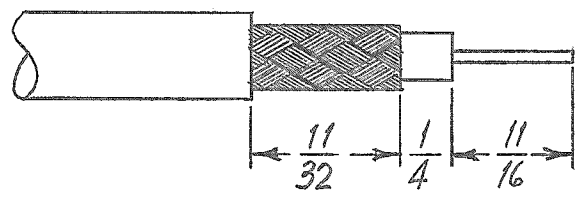

REF: TOOL (S401-35 #WT203)

SPECIFICATIONS
 SERIES: "C"
 NO. OF CONTACTS: ONE (1)
 TYPE OF CONTACT: MALE
 DIELECTRIC: TEFLON
ELECTRICAL DATA:
 MAX. PEAK OPR. VOLT: 1,500 VOLTS
 FREQ. LIMIT: 10,000 MHz
 NOMINAL IMPEDANCE: 50 OHM
CABLE ACCOMODATIONS:
 TYPE: RG-216/U
MATERIAL:
 EXTERNAL PARTS: BRASS
 CONTACTS: BERYLLIUM COPPER
 GASKET: NONE
FINISH:
 EXTERNAL PARTS: SILVER PLATE & RHODIUM FLASH
 CONTACTS: SILVER PLATE & GOLD FLASH
MATING CONNECTOR:
NOTE: CRIMP CLAMP TYPE

REQ. ITEM	PART NO.	MARTINENGO DESCRIPTION	SYMBOL
Ø	ORIG. RELEASE FOR PROD. 9.21.67	Ø RG.	Ø
X2	S401-35 ADDED, UPDATED MFG.	ENJ	
X1	"TOOL THOMAS & BETTS # WT-203" 2.2067	WHD	
SYM	DESCRIPTION	DATE	CH. NO.
UNLESS OTHERWISE SPECIFIED DIMENSIONS ARE IN INCHES AND INCLUDE CHEMICALLY APPLIED OR PLATED FINISHES		SCALE	
DECIMALS .X ± .05 .XX ± .01 .XXX ± .005	TOLERANCES	FRACTIONS ± 1/64 ANGLES ± 0° 30'	CODE C
		S 401-70 (2275)	
SEE SPECS.		MATERIAL	
SEE SPECS.		TYPE & TEMPER	
SEE SPECS.		HEAT TREAT. SPEC.	
SEE SPECS.		FINISH & SPEC. NO.	
H. AUSTIN 3.23.66		DRAWN	
MFG		CHECKED	
SAM		FINAL APPROVAL	
Ø		PL 201	