

REQ. PER UNIT	USED ON		
	MODEL	ASS'Y. NO.	DATE
			PL-238

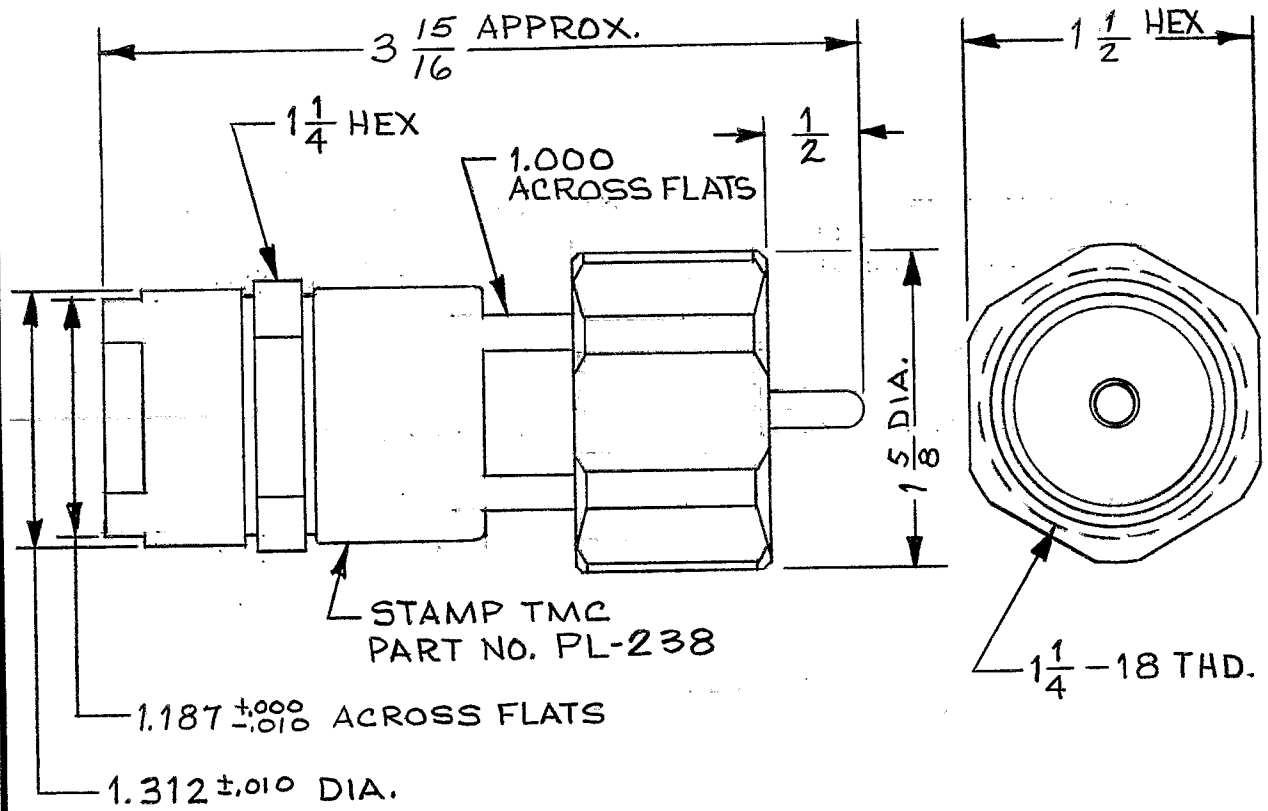

**SPECIFICATIONS:**

Series - LC  
 No. of Contacts - ONE (1)  
 Type of Contact - MALE (CAPTIVE)  
 Dielectric - TEFLON

**ELECTRICAL DATA:**

Max. Peak Opr. Volt - 5,000 V  
 Freq. Limit - 1,000 MCS  
 Nominal Impedance - 50 OHMS

**CABLE ACCOMMODATIONS:**

Type - RG-17,18,218,219/U

**MATING ACCOMMODATIONS:**

Type -

**MATERIAL:**

External Parts - BRASS  
 Contact - BERYLLIUM COPPER  
 Gasket - SILICONE RUBBER

**FINISH:**

External Parts - RHODIUM  
 Contact - GOLD FLASH

**PANEL:**

Max. Thickness NONE

**NOTE:**

- 1-REPLACEMENT FOR UG-154/U.
- 2-CENTER CONDUCTOR CAPTIVATED.

							REQ. ITEM	PART NO.	MARTINENG	DESCRIPTION	SYMBOL		
										<b>THE TECHNICAL MATERIEL CORP.</b> MAMARONECK, NEW YORK <b>PLUG, CONNECTOR</b> LC (M) TO CABLE			
									STOCK SIZE				
									MATERIAL				
SYM	DESCRIPTION	DATE	CH. NO.	DRAFTS	CHECKER	ENG. APP.			M. TANTILLO	10-4-63	10/4/63	BP	
UNLESS OTHERWISE SPECIFIED DIMENSIONS ARE IN INCHES AND INCLUDE CHEMICALLY APPLIED OR PLATED FINISHES		SCALE							TYPE & TEMPER	HEAT TREAT. SPEC.	DRAWN	CHECKED	FINAL APPROVAL
DECIMALS	TOLERANCES	FRACTIONS	CODE										PL-238
X ± .05		± 1/64	S401-70-										
.XX ± .01		ANGLES											
.XXX ± .005		± 0° 30'											
							FINISH & SPEC. NO.		ELEC. DES. APP.	MECH. DES. APP.			